

## Coupler with integral pipe fixation

- PE 100 SDR 11 (ISO S5)
- 10 bar Gas / 16 bar Water
- 4 mm pin connectors
- Limited path fusion indicators
- Removable centre stop

d [mm]	Code	kg	d1 [mm]	L [mm]
20	<b>753 911 606</b>	0.054	31	68
25	<b>753 911 607</b>	0.060	36	68
32	<b>753 911 608</b>	0.072	44	72
40	<b>753 911 609</b>	0.100	54	80
50	<b>753 911 610</b>	0.136	66	88
63	<b>753 911 611</b>	0.194	81	96

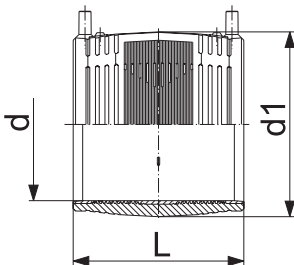

## Coupler

- PE 100 SDR 11 (ISO S5)
- 10 bar Gas / 16 bar Water
- 4 mm pin connectors
- Limited path fusion indicators
- Removable centre stop up to d160

d [mm]	Code	kg	d1 [mm]	L [mm]
75	<b>753 911 612</b>	0.287	96	110
90	<b>753 911 613</b>	0.421	113	125
110	<b>753 911 614</b>	0.697	138	145
125	<b>753 911 615</b>	0.738	154	158
140	<b>753 911 616</b>	0.968	172	168
160	<b>753 911 617</b>	1.390	196	180
180	<b>753 911 618</b>	1.750	219	194
200	<b>753 911 619</b>	2.350	244	208
225	<b>753 911 620</b>	3.193	273	224
250	<b>753 911 621</b>	4.210	304	244
280	<b>753 911 622</b>	5.675	340	252
315	<b>753 911 623</b>	8.000	382	268
355	<b>753 911 624</b>	12.110	432	290
400	<b>753 911 625</b>	15.993	487	290



## Elbow 90° with integral pipe fixation

- PE 100 SDR 11 (ISO S5)
- 10 bar Gas / 16 bar Water
- 4 mm pin connectors
- Limited path fusion indicators

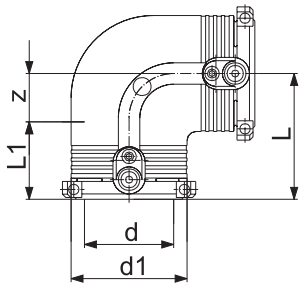

d [mm]	Code	kg	d1 [mm]	L [mm]	L1 [mm]	z [mm]
20	753 101 606	0.093	35	54	34	20
25	753 101 607	0.078	35	54	34	20
32	753 101 608	0.098	44	53	36	17
40	753 101 609	0.142	54	62	39	23
50	753 101 610	0.215	66	71	43	28
63	753 101 611	0.280	81	81	48	32



## Elbow 45° with integral pipe fixation

- PE 100 SDR 11 (ISO S5)
- 10 bar Gas / 16 bar Water
- 4 mm pin connectors
- Limited path fusion indicators

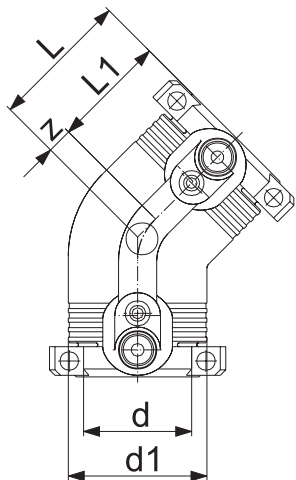

d [mm]	Code	kg	d1 [mm]	L [mm]	L1 [mm]	z [mm]
32	753 151 608	0.087	44	44	36	8
40	753 151 609	0.121	54	50	39	11
50	753 151 610	0.140	66	56	43	13
63	753 151 611	0.274	81	63	48	15



## Tee 90°, equal with integral pipe fixation

- PE 100 SDR 11 (ISO S5)
- 10 bar Gas / 16 bar Water
- 4 mm pin connectors
- Limited path fusion indicators

d [mm]	Code	kg	d1 [mm]	L [mm]	L1 [mm]	z [mm]	z1 [mm]	H [mm]
20	<b>753 211 606</b>	0.100	35	90	34	11	92	67
25	<b>753 211 607</b>	0.088	35	90	34	11	92	70
32	<b>753 211 608</b>	0.115	44	102	36	15	100	74
40	<b>753 211 609</b>	0.176	54	120	39	21	114	82
50	<b>753 211 610</b>	0.268	66	135	43	24	126	90
63	<b>753 211 611</b>	0.429	81	152	48	28	150	102

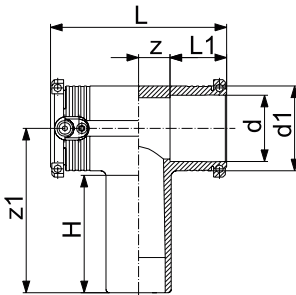

## Tee 90°, equal

- PE 100 SDR 11 (ISO S5)
- 10 bar Gas / 16 bar Water
- 4 mm pin connectors
- Limited path fusion indicators
- Two separate fusion zones

d [mm]	Code	kg	d1 [mm]	L [mm]	L1 [mm]	z [mm]	z1 [mm]	H [mm]
200	<b>753 201 819</b>	10.100	245	560	104	176	250	117
225	<b>753 201 820</b>	15.145	274	610	112	193	270	122
250	<b>753 201 821</b>	18.100	305	667	123	211	288	127

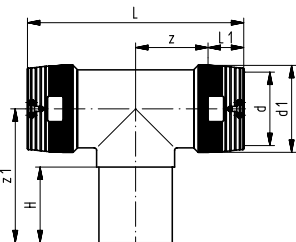



## Tee 90°, reduced

- PE 100 SDR 11 (ISO S5)
- 10 bar Gas / 16 bar Water
- 4 mm pin connectors
- Limited path fusion indicators
- Two separate fusion zones
- \*Two connected fusion zones

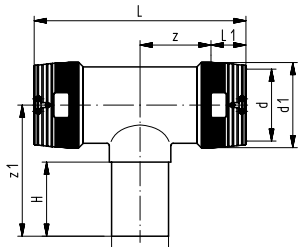

d [mm]	d2 [mm]	Code	kg	d1 [mm]	L [mm]	L1 [mm]	z [mm]	z1 [mm]	H [mm]
* 110	90	<b>753 211 034</b>	1.652	140	255	72	56	245	80
* 125	90	<b>753 211 035</b>	2.236	156	255	75	53	245	80
160	63	<b>753 211 037</b>	4.940	196	405	90	113	176	65
160	90	<b>753 211 039</b>	5.040	196	405	90	113	188	79
160	110	<b>753 211 040</b>	5.160	196	405	90	113	195	85
* 180	90	<b>753 211 041</b>	6.600	225	344	90	82	304	79
* 180	110	<b>753 211 042</b>	6.800	225	344	90	82	307	82
200	90	<b>753 211 059</b>	11.260	245	557	104	175	215	81
200	110	<b>753 211 060</b>	11.260	245	557	104	175	218	84
200	160	<b>753 211 063</b>	11.260	245	557	104	175	236	101
225	90	<b>753 211 069</b>	12.700	274	615	112	196	226	80
225	110	<b>753 211 070</b>	12.750	274	615	112	196	235	85
225	160	<b>753 211 073</b>	13.200	274	615	112	196	255	105
250	110	<b>753 211 080</b>	11.260	305	668	123	211	245	85
250	160	<b>753 211 083</b>	11.260	305	668	123	211	264	101



## Reducer with integral pipe fixation

- PE 100 SDR 11 (ISO S5)
- 10 bar Gas / 16 bar Water
- 4 mm pin connectors
- Limited path fusion indicators

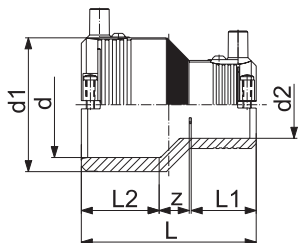

d [mm]	d2 [mm]	Code	kg	d1 [mm]	L [mm]	L1 [mm]	L2 [mm]	z [mm]
25	20	<b>753 901 639</b>	0.059	35	74	34	34	6
32	20	<b>753 901 640</b>	0.071	44	79	33	36	10
32	25	<b>753 901 641</b>	0.060	44	79	33	36	10
40	20	<b>753 901 644</b>	0.069	54	88	33	39	15
40	25	<b>753 901 645</b>	0.071	54	88	33	39	15
40	32	<b>753 901 646</b>	0.072	54	88	33	39	13
50	32	<b>753 901 651</b>	0.096	66	96	35	43	18
50	40	<b>753 901 652</b>	0.136	66	96	39	43	14
63	32	<b>753 901 656</b>	0.171	81	106	35	48	23
63	40	<b>753 901 657</b>	0.176	81	106	39	48	19
63	50	<b>753 901 658</b>	0.189	81	106	43	48	15



## End Cap with integral pipe fixation

- PE 100 SDR 11 (ISO S5)
- 10 bar Gas / 16 bar Water
- 4 mm pin connectors
- Limited path fusion indicators

d [mm]	Code	kg	d1 [mm]	L [mm]	L1 [mm]
20	<b>753 961 606</b>	0.038	35	52	44
25	<b>753 961 607</b>	0.030	35	52	44
32	<b>753 961 608</b>	0.080	44	52	44
40	<b>753 961 609</b>	0.074	54	56	47
50	<b>753 961 610</b>	0.086	66	60	49
63	<b>753 961 611</b>	0.154	81	66	54

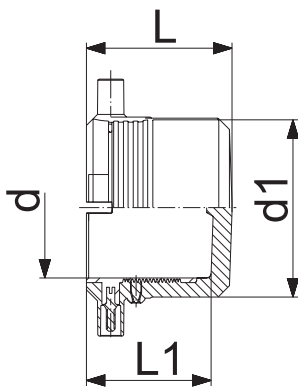

## Transition Coupler PE/brass (Ms 58) Male Thread

- PE 100 SDR 11 (ISO S5)
- 10 bar Gas / 16 bar Water
- With integral pipe fixation
- 4 mm pin connectors
- Limited path fusion indicators
- Supplied as kit

d [mm]	R [inch]	Code	kg	d1 [mm]	L [mm]	s [mm]
20	1/2	<b>720 920 756</b>	0.217	31	110	30
20	1	<b>720 920 754</b>	0.344	44	124	40
25	3/4	<b>720 920 757</b>	0.280	36	111	35
25	1	<b>720 920 763</b>	0.364	44	124	40
32	1/2	<b>720 920 764</b>	0.235	44	121	30
32	3/4	<b>720 920 765</b>	0.287	44	122	35
32	1	<b>720 920 758</b>	0.355	44	117	40
32	1 1/4	<b>720 920 766</b>	0.543	54	135	50
32	1 1/2	<b>720 920 767</b>	0.685	60	143	60
32	2	<b>720 920 768</b>	1.000	81	157	70
40	1	<b>720 920 771</b>	0.387	54	133	40
40	1 1/4	<b>720 920 759</b>	0.541	54	127	50
40	1 1/2	<b>720 920 772</b>	0.694	66	143	60
40	2	<b>720 920 773</b>	0.992	81	157	70
50	1	<b>720 920 776</b>	0.416	66	141	40
50	1 1/4	<b>720 920 777</b>	0.578	66	143	50
50	1 1/2	<b>720 920 760</b>	0.670	66	135	60
50	2	<b>720 920 778</b>	0.994	81	157	70
63	1	<b>720 920 781</b>	0.460	81	151	40
63	1 1/4	<b>720 920 782</b>	0.626	81	153	40
63	1 1/2	<b>720 920 783</b>	0.741	81	153	60
63	2	<b>720 920 761</b>	1.005	81	147	70

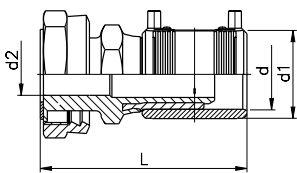



## Female Thread

- PE 100 SDR 11 (ISO S5)
- 10 bar Gas / 16 bar Water
- With integral pipe fixation
- 4 mm pin connectors
- Limited path fusion indicators
- Supplied as kit

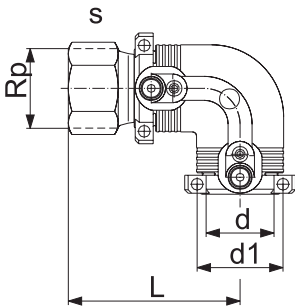

d [mm]	Rp [inch]	Code	kg	d1 [mm]	L [mm]	s [mm]
32	1	<b>720 100 258</b>	0.365	44	89	40
40	1 ¼	<b>720 100 259</b>	0.556	54	100	50
50	1 ½	<b>720 100 260</b>	0.819	66	109	60
63	1	<b>720 100 281</b>	1.420	81	123	70
63	1 ¼	<b>720 100 282</b>	1.380	81	123	70
63	1 ½	<b>720 100 283</b>	1.305	81	123	70
63	2	<b>720 100 261</b>	1.165	81	123	70



## Transition Coupler PE/brass (Ms 58) with loose Nut

- PE 100 SDR 11 (ISO S5)
- With integral pipe fixation
- 4 mm pin connectors
- Limited path fusion indicators
- Delivered as a kit. Further combinations modular system with threaded adapter and reductions
- Incl. flat gasket for water applications (KTW / WRAS approved)

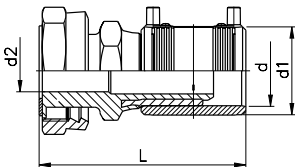

d [mm]	Rp [inch]	Code	kg	d1 [mm]	d2 [mm]	L [mm]
25	¾	<b>720 910 007</b>	0.240	36	15	104
25	1	<b>720 910 017</b>	0.315	36	16	106
32	1	<b>720 910 008</b>	0.342	44	20	110
32	1 ¼	<b>720 910 018</b>	0.460	44	22	114
32	1 ½	<b>720 910 028</b>	0.480	44	22	114
40	1	<b>720 910 009</b>	0.465	54	21	119
40	1 ¼	<b>720 910 019</b>	0.520	54	25	123
40	1 ½	<b>720 910 029</b>	0.595	54	28	123
50	1	<b>720 910 020</b>	0.685	66	20	128
50	1 ¼	<b>720 910 030</b>	0.730	66	25	133
50	1 ½	<b>720 910 010</b>	0.774	66	29	133
50	2	<b>720 910 040</b>	0.980	66	36	137
63	1	<b>720 910 021</b>	1.025	81	20	137
63	1 ¼	<b>720 910 031</b>	1.060	81	25	141
63	1 ½	<b>720 910 041</b>	1.070	81	29	141
63	2	<b>720 910 011</b>	1.235	81	36	145



## Tee 90°, equal with integral pipe fixation

- PE 100 SDR 11 (ISO S5)
- 10 bar Gas / 16 bar Water
- 4 mm pin connectors
- Limited path fusion indicators

d [mm]	Code	kg	d1 [mm]	L [mm]	L1 [mm]	z [mm]	z1 [mm]	H [mm]
20	<b>753 211 606</b>	0.100	35	90	34	11	92	67
25	<b>753 211 607</b>	0.088	35	90	34	11	92	70
32	<b>753 211 608</b>	0.115	44	102	36	15	100	74
40	<b>753 211 609</b>	0.176	54	120	39	21	114	82
50	<b>753 211 610</b>	0.268	66	135	43	24	126	90
63	<b>753 211 611</b>	0.429	81	152	48	28	150	102

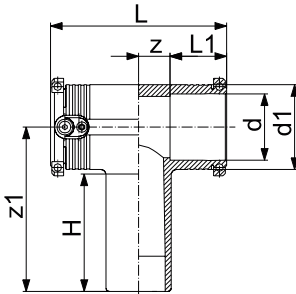

## Tee 90°, equal

- PE 100 SDR 11 (ISO S5)
- 10 bar Gas / 16 bar Water
- 4 mm pin connectors
- Limited path fusion indicators
- Two separate fusion zones

d [mm]	Code	kg	d1 [mm]	L [mm]	L1 [mm]	z [mm]	z1 [mm]	H [mm]
200	<b>753 201 819</b>	10.100	245	560	104	176	250	117
225	<b>753 201 820</b>	15.145	274	610	112	193	270	122
250	<b>753 201 821</b>	18.100	305	667	123	211	288	127

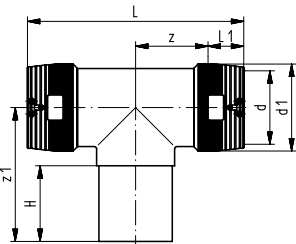



## Transition Elbow 90° PE/brass (Ms 58) Female Thread

- PE 100 SDR 11 (ISO S5)
- 10 bar Gas / 16 bar Water
- With integral pipe fixation
- 4 mm pin connectors
- Limited path fusion indicators
- Supplied as kit

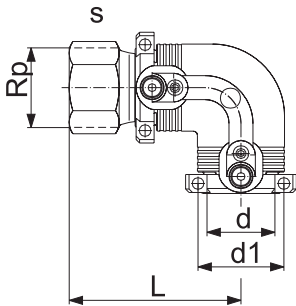

d [mm]	Rp [inch]	Code	kg	d1 [mm]	L [mm]	s [mm]
32	1	<b>720 100 258</b>	0.365	44	89	40
40	1 ¼	<b>720 100 259</b>	0.556	54	100	50
50	1 ½	<b>720 100 260</b>	0.819	66	109	60
63	1	<b>720 100 281</b>	1.420	81	123	70
63	1 ¼	<b>720 100 282</b>	1.380	81	123	70
63	1 ½	<b>720 100 283</b>	1.305	81	123	70
63	2	<b>720 100 261</b>	1.165	81	123	70



## Transition Coupler PE/brass (Ms 58) with loose Nut

- PE 100 SDR 11 (ISO S5)
- With integral pipe fixation
- 4 mm pin connectors
- Limited path fusion indicators
- Delivered as a kit. Further combinations modular system with threaded adapter and reductions
- Incl. flat gasket for water applications (KTW / WRAS approved)

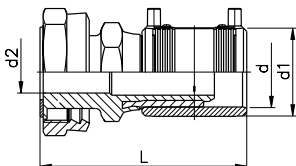

d [mm]	Rp [inch]	Code	kg	d1 [mm]	d2 [mm]	L [mm]
25	¾	<b>720 910 007</b>	0.240	36	15	104
25	1	<b>720 910 017</b>	0.315	36	16	106
32	1	<b>720 910 008</b>	0.342	44	20	110
32	1 ¼	<b>720 910 018</b>	0.460	44	22	114
32	1 ½	<b>720 910 028</b>	0.480	44	22	114
40	1	<b>720 910 009</b>	0.465	54	21	119
40	1 ¼	<b>720 910 019</b>	0.520	54	25	123
40	1 ½	<b>720 910 029</b>	0.595	54	28	123
50	1	<b>720 910 020</b>	0.685	66	20	128
50	1 ¼	<b>720 910 030</b>	0.730	66	25	133
50	1 ½	<b>720 910 010</b>	0.774	66	29	133
50	2	<b>720 910 040</b>	0.980	66	36	137
63	1	<b>720 910 021</b>	1.025	81	20	137
63	1 ¼	<b>720 910 031</b>	1.060	81	25	141
63	1 ½	<b>720 910 041</b>	1.070	81	29	141
63	2	<b>720 910 011</b>	1.235	81	36	145





## Branch Fitting

- PE 100 SDR 11 (ISO S5)
- 10 bar Gas / 16 bar Water
- Branch Fitting complete, incl. lower part and 3 screws
- Additional fixing with snatch hinge
- Electrofusion outlet with integrated pipe fixation
- Protected wire without medium contact
- 4 mm pin connectors
- Limited path fusion indicators
- \* Delivered without lower part. Pipe fixation with multiple use assembly tool no. 193 281 027

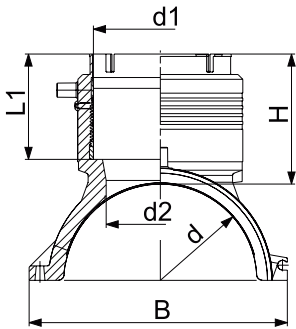

d [mm]	d1 [mm]	Code	kg	H [mm]	L [mm]	L1 [mm]	B [mm]	d2 [mm]
110	90	<b>193 135 009</b>	1.074	101	220	82	164	65
110	110	<b>193 135 010</b>	1.152	107	220	88	164	65
125	90	<b>193 135 019</b>	1.134	101	220	82	179	65
125	110	<b>193 135 020</b>	1.258	107	220	88	179	65
* 140	90	<b>193 135 029</b>	1.134	101	220	81	195	65
* 140	110	<b>193 135 030</b>	1.258	107	220	87	195	65
160	90	<b>193 135 039</b>	1.444	102	240	82	215	65
160	110	<b>193 135 040</b>	1.523	108	240	88	215	86
160	125	<b>193 135 041</b>	1.738	129	240	99	215	86
180	90	<b>193 135 049</b>	1.714	102	260	82	237	65
180	110	<b>193 135 050</b>	1.782	108	260	88	237	86
180	125	<b>193 135 051</b>	1.972	129	260	99	237	86
200	90	<b>193 135 059</b>	1.811	102	260	82	253	65
200	110	<b>193 135 060</b>	1.879	108	260	88	253	86
200	125	<b>193 135 061</b>	2.069	129	260	99	253	86
225	90	<b>193 135 069</b>	1.959	102	260	82	287	65
225	110	<b>193 135 070</b>	2.027	108	260	88	287	86
225	125	<b>193 135 071</b>	2.217	129	260	99	287	86
250	90	<b>193 135 079</b>	2.116	102	260	82	312	65
250	110	<b>193 135 080</b>	2.184	108	260	88	312	86
250	125	<b>193 135 081</b>	2.374	129	260	99	312	86



## Branch Fitting Toploa

- PE 100 SDR 11 (ISO S5)
- 10 bar Gas / 16 bar Water
- Branch Fitting for assembling as Topload with tool 799.350.477; angle adaptor (799.350.340) for fusion eable required
- Electrofusion outlet with integrated pipe fixation
- Protected wire without medium contact
- 4 mm pin connectors
- Limited path fusion indicators

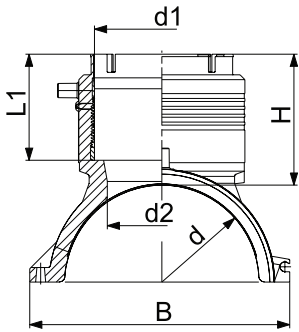

d [mm]	d1 [mm]	Code	kg	H [mm]	L [mm]	L1 [mm]	B [mm]	d2 [mm]
280	90	<b>193 135 289</b>	1.180	102	260	82	243	65
280	110	<b>193 135 290</b>	1.280	108	260	88	243	86
280	125	<b>193 135 291</b>	1.480	129	260	99	243	86
315 - 355	90	<b>193 135 309</b>	1.180	102	260	82	249	65
315 - 355	110	<b>193 135 310</b>	1.280	108	260	88	249	86
315 - 355	125	<b>193 135 311</b>	1.480	129	260	99	249	86
400 - 450	90	<b>193 135 329</b>	1.180	102	260	82	256	65
400 - 450	110	<b>193 135 330</b>	1.280	108	260	88	256	86
400 - 450	125	<b>193 135 331</b>	1.280	129	260	99	256	86
500 - 630	90	<b>193 135 159</b>	1.060	102	260	82	263	65
500 - 630	110	<b>193 135 160</b>	1.160	108	260	88	263	86
500 - 630	125	<b>193 135 161</b>	1.360	129	260	99	263	86



## Transition Adaptor PE/brass (Ms 58) Female thread

- PE 100 SDR 11 (ISO S5)
- 10 bar Gas / 16 bar Water
- For ELGEF® Plus Couplers and Fittings

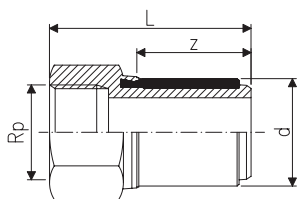

d [mm]	Rp [inch]	Code	kg	L [mm]	z [mm]
32	1	<b>720 920 208</b>	0.250	71	35
40	1 ¼	<b>720 920 209</b>	0.397	77	39
50	1 ½	<b>720 920 210</b>	0.589	81	43
63	1	<b>720 920 221</b>	1.071	89	47
63	1 ¼	<b>720 920 231</b>	1.027	89	47
63	1 ½	<b>720 920 241</b>	0.950	89	47
63	2	<b>720 920 211</b>	0.800	89	47



## Transition Adaptor PE/brass (Ms 58) Male thread

- PE 100 SDR 11 (ISO S5)
- 10 bar Gas / 16 bar Water
- For ELGEF® Plus Couplers and Fittings

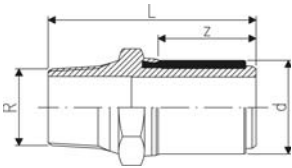

d [mm]	R [inch]	Code	kg	L [mm]	z [mm]
20	½	720 920 706	0.151	75	33
25	¾	720 920 707	0.195	76	33
32	1	720 920 708	0.273	80	35
32	1 ¼	720 920 718	0.389	82	35
32	1 ½	720 920 728	0.454	82	35
40	1	720 920 719	0.370	84	39
40	1 ¼	720 920 709	0.425	86	39
40	1 ½	720 920 729	0.490	86	39
50	1	720 920 720	0.479	88	43
50	1 ¼	720 920 730	0.546	90	43
50	1 ½	720 920 710	0.528	90	43
63	1 ¼	720 920 721	0.702	94	47
63	1 ½	720 920 731	0.698	94	47
63	2	720 920 711	0.792	98	47



## Transition Adaptor PE/brass Loose nut (Ms 58)

- PE 100 SDR 11 (ISO S5)
- For ELGEF® Plus Couplers and Fittings
- Incl. flat gasket for water applications (KTW / WRAS approved)

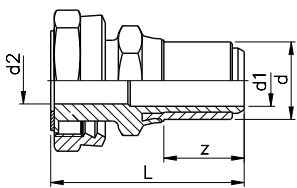

d [mm]	Rp [inch]	Code	kg	d2 [mm]	L [mm]	z [mm]
25	¾	720 920 007	0.165	15	68	32
25	1	720 920 017	0.240	16	70	32
32	1	720 920 008	0.255	20	72	34
32	1 ¼	720 920 018	0.374	22	76	34
32	1 ½	720 920 028	0.393	22	76	34
40	1	720 920 009	0.349	21	77	38
40	1 ¼	720 920 019	0.406	25	81	38
40	1 ½	720 920 029	0.480	28	81	38
50	1	720 920 020	0.532	20	82	42
50	1 ¼	720 920 030	0.577	25	87	42
50	1 ½	720 920 010	0.621	29	87	42
50	2	720 920 040	0.831	36	91	42
63	1	720 920 021	0.816	20	87	46
63	1 ¼	720 920 031	0.850	25	91	46
63	1 ½	720 920 041	0.862	29	91	46
63	2	720 920 011	1.025	36	95	46

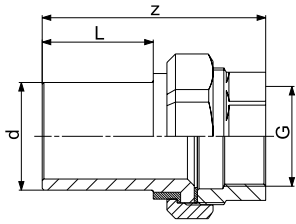

## Union Adaptor

- With female thread and PE-union end
- The Code Nr. includes the entire union (galvanised)
- **PE 100 SDR 11 (ISO S5)**

d [mm]	Rp [inch]	Code	kg	L [mm]	L2 [mm]	SW1 [mm]	G [inch]
20	1/2	<b>701 485 560</b>	0.152	94	52	27	1
25	3/4	<b>701 485 561</b>	0.252	100	52	32	1 1/4
32	1	<b>701 485 562</b>	0.331	108	54	34	1 1/2
40	1 1/4	<b>701 485 563</b>	0.590	114	57	43	2
50	1 1/2	<b>701 485 564</b>	0.645	124	65	50	2 1/4
63	2	<b>701 485 565</b>	0.975	134	65	61	2 3/4